

Site monitoring report

Please find detailed below the report for the site monitoring undertaken. If you should have any queries or require any photographs taken on, please do not hesitate to contact me.

Site Name: Terminus Drive, Pitsea Hall Lane

File Ref: 32 457 09

Operator: Heard Environmental

Site Representative: Steven Carpenter and James Heard– Heard Environmental

Visit no: 1

Date: 19 Dec 2024

Time on site: 11:00

Time off site: 12:15

Monitoring Officer: Claire Tomalin Tel No: 03330 136821

Site Co-ordinator: as above

Permission no's:

ESS/13/15/BAS - WTS

Constraints:

- Weather: **Dry/** Windy / Rain / Snow
- Noise: **Acceptable/** Not acceptable / N/A
- Approach roads: Dry / Dusty / **Wet / Muddy / Flooded**
- Ground: Dry / Dusty / **Wet / Damp / Muddy / Flooded**
- Access: Obstructed / **Not Obstructed** / Mud on Road / Ice / Slippery
- Wheel cleaning: Washer / Spinner / Sweeper / **none** N/A
- Hose: In use / Not in Use / **N/A**
- Machinery: Working / **Not working**
- In correct position: Yes / **No** / N/A

- Stockpiles: **Height = Exceeding permitted limits 4 to 5 m**
- Bunds: **Profiled / Grassed / Some weeds / NA**

Actions from lads visit:

These actions remain as from the visit in Sept 2023:

- HIGH PRIORITY Reduce inert stockpile west end of site to below 4m (condition 17 of ESS/13/15/BAS) and create at least a 2m stand off to fence with railway fencing in accordance with drawing ref 12.1831/P201 Rev Z.

Comment: The stockpile during the earlier part of 2024 had been brought back from the railway line boundary fence, and the boundary chain link fence had been replaced with a palisade fence. The stockpile overall height had been reduced by about a metre. At his visit the standoff from the railway line boundary had been reduced and while some material had been removed from the top of the stockpile, part of the stockpile was above 4m. The stockpiles easterly extent has slightly been reduced, but not significantly. Storage of materials not in accordance with approved layout drawing

- HIGH PRIORITY Relocate inert reprocessing screening and crushing to west of office building, in accordance with condition 5.

Comment: Not relocated

- HIGH PRIORITY all plant to operate at ground level, in accordance with condition 18.

Comment: No plant operational at the time of the visit, crusher was located on the ground, but not operating.

- Address drainage problem along internal access road, to prevent future flooding.

Comment: Not resolved standing water along western half of internal access road. The drainage scheme approved under condition 32 has not been fully implemented. Surfacing in front of the waste building has broken up.

- Reduce waste stockpiles within main waste processing building, to enable sorting to be carried out within the building.

Comment: No substantial decrease in the volume of waste stored in the building, preventing the use of a trommel in the building.

Install retaining walls as required by planning permission.

Comment: No progress, the site is not laid out in accordance with the approved drawing, which included the formation of storage bays with retaining walls.

- Remove full skips from Network Rail access track - preferably process material within the skips and place empty skips in the skip storage area.

Comment: On a previous visit earlier in 2024 this area had been partly cleared, but now full skips line the Network Rail access area and the area allocated for empty skips is now also being utilised for full skips.

- Reduce litter on site particularly adjacent to boundaries.

Comment: Litter outside the site boundaries, but not necessarily all originating from Heard's facility.

Inspection Results Summary:

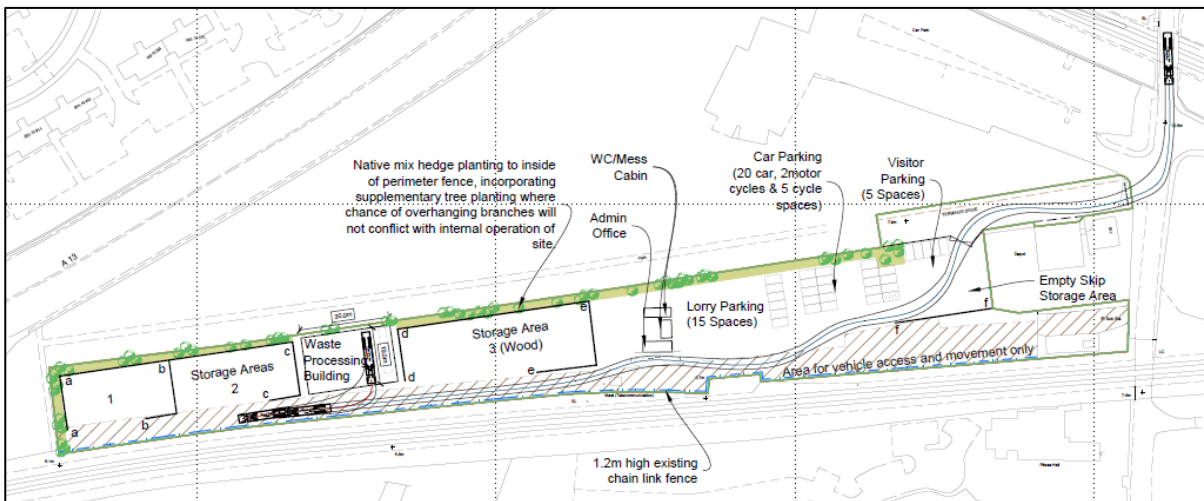

West of Waste Processing Building

This area remains largely occupied by inert waste that requires screening. The stockpile was in excess of permitted 4 metres in places, approximately 5m. Some material has been removed, but the majority remains in place. There is a standoff to the railway line, but not to a width to be in accordance with the approved layout drawing, extract above.

The stockpile is visible from the elevated A13 Pitsea Flyover and from the adjacent PRow. The stockpile prevents use of the western end of the site for inert waste recycling, ensuring it located as far away as possible from Cromwell Manor a Listed event venue.

Waste Processing Building

The building was being used to store unsorted skip waste, awaiting sorting. There was no sorting equipment in the building and no room for sorting equipment. It was intended a trommel and picking station would be located in the building to sort waste. Use of the building for storage only prevents the use of trommels and/or picking station that would enable separate of recyclables from skip waste.

Storage Area east of the Waste Processing Building

This area is permitted to be used for storage of wood.

The area was being used to store unsorted inert waste, mainly concrete.

Processing of inerts namely crushing has taken place in this area. The screener has been removed from site and JH explained he can't afford to repair or hire in alternative plant.

This area was originally planned for wood waste storage and processing with inert waste processing to located west of the main building, to reduce potential impact on adjacent uses south of the railway line.

Site Office

The two storey ISO containers and weighbridge office has been vacated and relocated to a portable office southwest of the site access, which has been on site for some time but has now been brought into use as offices and weighbridge office. There is no planning permission for this building or any building in this location. The weighbridge itself remains in its original location.

Area east of the redundant site office and weighbridge

This area is permitted for lorry parking and staff parking. The area is being used for storage of recovered aggregates, within 3m high concrete push wall storage bays. Use of this area for this purpose is also contrary to the planning permission as it brings operations closer to Cromwell Manor likely to give rise to potential impacts.

Large roro type skips have been placed along the north boundary of the site and appear to be full.

Internal access road

The internal access road beyond the weighbridge has been allowed to deteriorate and in front of the building is damaged.

The internal access road close to the gates had been swept, much fine dirt material was still on the access road.

Skip storage area adjacent to the site entrance

This area is for empty skip storage only. The area was being used for storage of full skips.

Network Rail Entrance & Track

Skips were stored in this area. There is no planning permission for storage of full or empty skips in this area. These should be removed to ensure no activity, other than activities by Network Rail occur in this area, which is close to the rear of Cromwell Manor. The skips should be relocated within the site. Preferably the waste in the skips should be processed, the waste residue removed from site and the empty skips placed in the skip storage area. There was still a route wide enough for a vehicle to pass should Network Rail need access.

Visitor Parking Area

This is being used for staff parking and temporary mobile buildings. There is no planning permission for temporary or permanent buildings in this location, one of which is now being

used for the weighbridge office. Locating the buildings close to the access entrance brings continual activity closer to Cromwell Manor to the south.

Overview re operations.

JH acknowledged had not achieved progress as agreed in the action plan, financial constraints were restricting addressing issues on site. JH stated he intended to get out of skip business and focus on demolition business and consider alternative uses for parts of the site.

Enforcement Officer was unavailable at the visit due to illness, CT agreed to discuss with the enforcement officer but advised it was likely a breach of condition notice would be served.

Permission under 2017 EIA regulations? No

Actions to be taken before next site visit:

These actions remain as from last visit:

- HIGH PRIORITY Reduce inert stockpile west end of site to below 4m and create at least 2m stand off to fence with railway line to prevent damage to the fence.
- HIGH PRIORITY Relocate inert reprocessing screening and crushing to west of building.
- Address drainage problem along access road, to prevent future flooding and potential for mud to be carried out onto the public highway.
- Reduce waste stockpiles within main waste processing building, to enable sorting of skip waste to be carried out within the building.
- Install retaining walls and layout out site as required by planning permission.
- Remove full skips from Network Rail access track -preferably process material within and place empty skip in skip storage area.
- Remove redundant ISO officer containers and locate replacement building adjacent to weighbridge.

Note: The actions noted in this report are required in order to ensure adequate progress is made and to avoid further enforcement action against a breaches of planning control.